

The perfect solution for a comfortable home



NEW Perfera wall-mounted unit



Find out more at www.daikin.co.uk



Perfera

Great looks that deliver
even smoother air flow

Perfera wall-mounted unit

Designed for comfort

Perfera makes cool living and working a breeze

Whatever the weather's doing outside, inside you want optimum comfort throughout the day. Perfera will keep the room temperature in your living or working space at the ideal level, whether you want a cooling summer breeze or cosy winter warmth. It means you'll be able to get on with relaxing, working or just enjoying yourself in perfect comfort. The stylishly designed front panel, whisper-quiet operation and efficient circulation of cooled or heated air make every room the place to be.

A stylish combination of heating and cooling

Perfera's climate control pedigree offers you the very best in heating and cooling options. Designed to blend effortlessly into any decor, this wall-mounted unit is a stylish addition to your living space. The new Perfera now offers 'heat boost'; an ingenious feature that takes the chill off the air in an instant.

Features of the new Perfera

- › Seasonal efficiency values up to A+++ in cooling and heating.
- › Heat boost quickly heats up your home when starting up your air conditioner. Set temperature is reached 14% faster than a regular air conditioner (pair only).
- › Using electrons to trigger chemical reactions with airborne particles, the Flash Streamer breaks down allergens such as pollen and fungal spores, and removes bothersome odours providing a better, cleaner air.
- › Silver allergen removal and air purifying filter captures allergens such as pollen to ensure a steady supply of clean air.
- › Titanium apatite deodorising filter decomposes unpleasant smells such as tobacco and pet odours
- › Voice command via Amazon Alexa or Google Assistant to control main functions such as set point, operation mode, fan speed, etc.
- › Whisper quiet operation: down to 19dBA sound pressure level.
- › 3-D air flow combines vertical and horizontal auto swing to circulate a stream of warm or cool air right into the corners of even large spaces.
- › 2-area motion detection sensor: air flow is sent to a zone other than where the person is located at that moment. If no people are detected, the unit will automatically switch over to the energy-efficient setting.



Intelligent

powerful - quiet

3-D 3-D air flow

With a press of a button on the remote control, this function combines vertical and horizontal auto-swing to circulate a stream of cool/warm air right into the corners of even the largest spaces.

Silent operation

Perfera uses a **specially designed fan** that optimises airflow and creates high energy efficiency at low sound levels. For even higher energy efficiency, Daikin has also designed a new fan that fits snugly into Perfera's compact dimensions.

Together, the fan and heat exchanger produce top energy performance, yet operate at a sound level that is practically inaudible. Shhh!





Air quality

Flash streamer/ titanium apatite deodorising filter

The Flash Streamer uses electrons to trigger chemical reactions with airborne particles. This removes allergens such as pollens and fungal spores, eliminates unpleasant odours and provides better, cleaner air. At the same time, the titanium apatite deodorising filter works hard to combat smells such as tobacco smoke and pets.



FLASH STREAMER

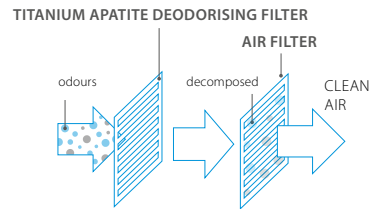

Silver allergen removal filter

The silver allergen removal and air purifying filter captures allergens such as pollen to ensure a steady supply of clean air.

Unique heating feature



Heat boost

Heat boost quickly heats up your home when starting up your air conditioner. The set temperature is reached 14% faster* than with a regular air conditioner (pair only).



*Heat Plus test condition: 50 class, outdoor temperature 2°C - Indoor temperature 10°C, R/C setting: 23°C

Technology meets design for the ideal climate solution

Sheer bliss

While the outside of the new Perfera is all about eye-catching design and style, it's the inside that creates the perfect indoor climate. And once Perfera has generated the exact air temperature you set, the wider flap ensures a stronger, more consistent flow of air that is distributed evenly thanks to the clever 3-D airflow. The Perfera has been redesigned with more compact dimensions to reduce the width of the unit by more than 30 mm. The result is a wall-mounted unit that is so discreet it is almost like a piece of art – a masterpiece, you might say!

Wide Louvre

The wider louvre design enables you to direct hot or cool air in the exact direction you want.



The side of the panel emphasises the strong airflow of the unit



Reduced dimensions



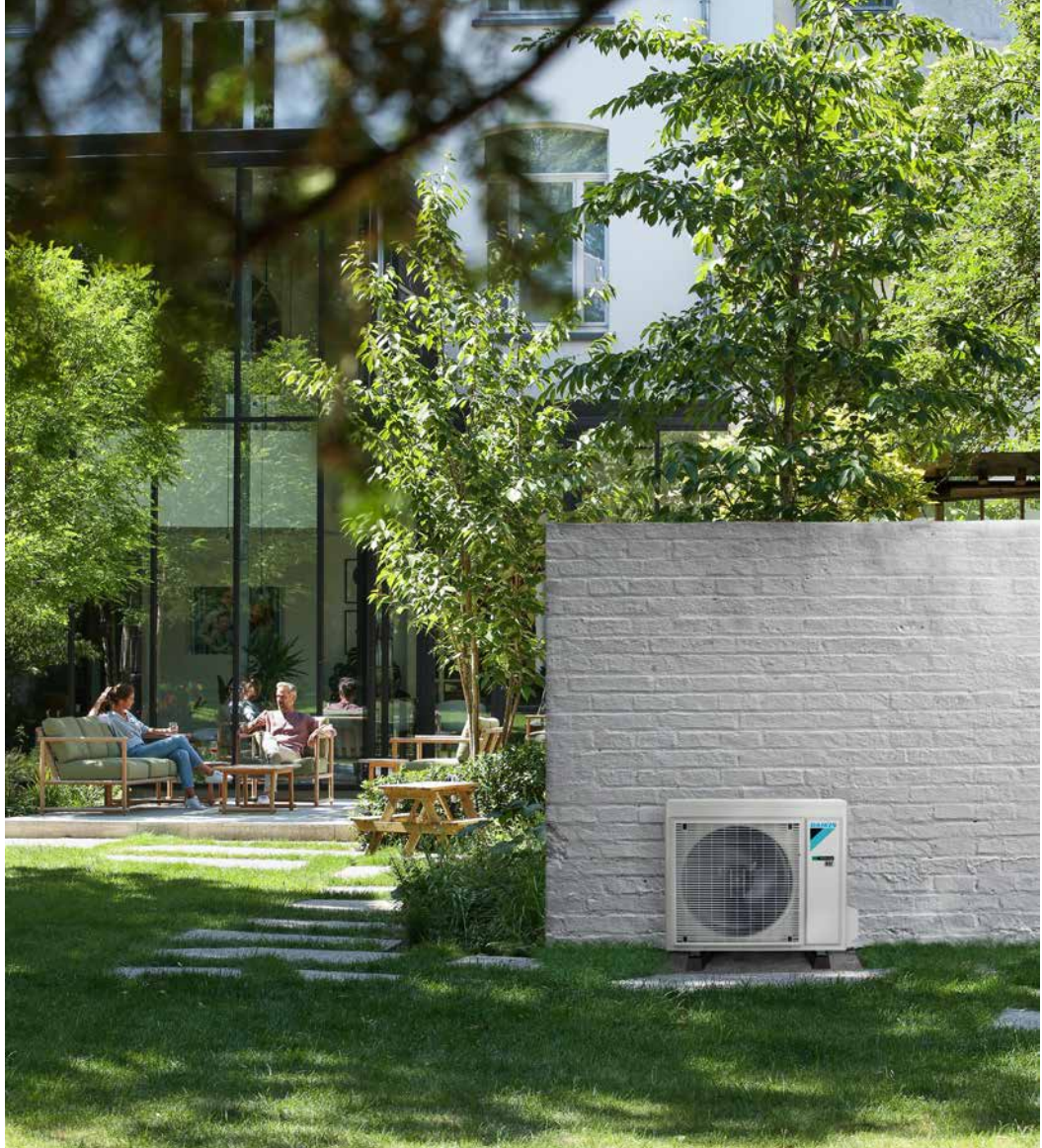

Let's talk about Energy efficiency

Energy label

The enhanced design of the Perfera boosts energy efficiency even further compared with previous models. It boasts a seasonal energy efficiency ratio (SEER) of up to 8.65 and a seasonal coefficient of performance (SCOP) of up to 5.10. This gives the Perfera **best-in-class performance**, with seasonal efficiency values up to A+++ in cooling and heating resulting in low running costs.

The Perfera is an energy-saving winner from every angle.

up to



in cooling

up to



in heating

Sleep comfortably

with the new Perfera



Night set mode

To help you sleep more comfortably, Daikin night set mode prevents overheating or overcooling during the night. If the timer is switched on, the unit will automatically set the temperature 2°C cooler when heating and 0.5°C warmer when cooling. This keeps the ambient temperature nice and even – and prevents rapid changes that could disturb your sleep.



Outdoor silent operation

To ensure a quiet environment for the neighbourhood you have the option to lower the operation sound of the outdoor unit by 3 dB(A) via remote control.



Econo mode

The Econo mode reduces power consumption and prevents overloading your electrical circuits when other household appliances are also in use. By activating the Econo mode, maximum operating power and energy consumption are reduced by around 30% during start-up.



2 area motion detection sensor

Air flow is sent to a zone other than where the person is located at that moment. Detection operates in two directions; left and right. If no people are detected, the unit will automatically switch over to the energy-efficient setting.



Application



Extended operation range

The Perfera is suitable for all climates, even withstanding severe weather conditions with an operation range down to -20°C and up to 50°C.



Pair or multi connection

The Perfera can be used in a single room set-up, with one indoor unit connected to one outdoor unit, or in a multiple room application with a maximum of **five indoor units connected to one outdoor unit**. The outdoor unit can be installed on the roof, terrace or against an outside wall.

Wide product range

- › The Perfera has a wide product range, including a 15 class for multi applications
- › It offers eight capacities: 15, 20, 25, 35, 42, 50, 60 and 71 class



Control your climate from anywhere

Flexible control

The indoor unit is easy to control with the infrared remote control supplied as standard. It also comes equipped with a weekly timer, enabling you to programme a seven-day schedule with four different operations per day.

You can also manage Perfera using your smartphone. Simply connect to Wi-Fi and download the [Daikin ONEcta app](#) to begin creating the perfectly comfortable climate for your home.

NEW Control your system and enjoy maximum comfort, just by using your voice. Via Amazon Alexa or Google Assistant you can control main functions such as temperature set point, operation mode, fan speed, and much more!

Your benefits

- › Access to various features for controlling your internal climate
- › Manage the temperature, operating mode, air purification and fans with the interactive thermostat
- › Create different operating schedules and modes
- › Monitor energy consumption

Intuitive online and voice control

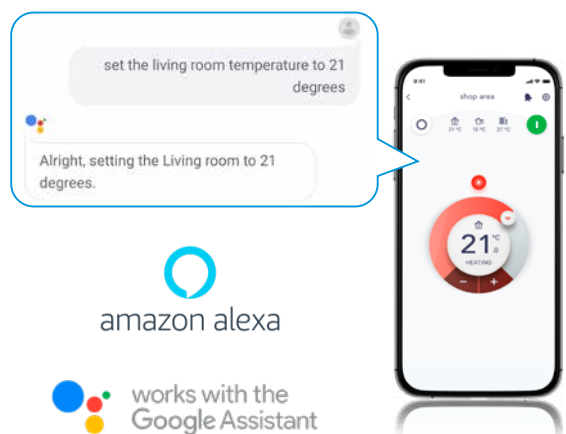

Perfera for optimal comfort thanks to High energy efficiencies

perfera **BLUEEVOLUTION**
FTXM-R + RXM-R



Indoor Units			FTXM20R	FTXM25R	FTXM35R	FTXM42R	FTXM50R	FTXM60R	FTXM71R
Capacity	UK Total Cooling	kW	1.95	2.44	3.32	4.11	4.89	5.86	6.94
	UK Sensible Cooling	kW	1.95	1.73	2.31	2.74	3.55	3.84	4.57
	Nominal Cooling	kW	2.0	2.5	3.4	4.2	5.0	6.0	7.1
	Nominal Heating	kW	2.5	2.8	4.0	5.4	5.8	7.0	8.2
Seasonal Efficiency (EN14825) COOLING	Energy Label		A+++	A+++	A+++	A++	A++	A++	A++
	Pdesign	kW	2.0	2.5	3.4	4.2	5.0	6.0	7.1
	SEER		8.65	8.65	8.65	7.85	7.41	6.90	6.2
	Annual Energy Consumption	kWh	81	101	137	187	236	304	401
Seasonal Efficiency (EN14825) HEATING	Energy Label		A+++	A+++	A+++	A++	A++	A+	A+
	Pdesign	kW	2.3	2.4	2.5	4.0	4.6	4.8	6.2
	SCOP		5.10	5.10	5.10	4.71	4.71	4.30	4.10
	Annual Energy Consumption	kWh	631	659	686	1189	1368	1562	2117
Air Flow Rate (Cooling)	High / Med / Low / Silent	m³/sec	0.175 / 0.125 / 0.095 / 0.072	0.175 / 0.127 / 0.095 / 0.068	0.188 / 0.130 / 0.100 / 0.070	0.198 / 0.150 / 0.108 / 0.072	0.263 / 0.233 / 0.190 / 0.138	0.278 / 0.233 / 0.197 / 0.152	0.282 / 0.250 / 0.203 / 0.167
Dimensions	Height	mm	295	295	295	295	299	299	299
	Width	mm	778	778	778	778	998	998	998
	Depth	mm	272	272	272	272	292	292	292
Weight		kg	10	10	10	10	14.5	14.5	14.5
Sound Pressure (Cooling)	High / Med / Low / Silent	dBa	41 / 33 / 25 / 19	41 / 33 / 25 / 19	45 / 33 / 29 / 19	45 / 39 / 30 / 21	44 / 40 / 36 / 27	46 / 42 / 37 / 30	47 / 43 / 38 / 32
Sound Pressure (Heating)	High / Med / Low / Silent	dBa	39 / 34 / 26 / 20	39 / 34 / 27 / 20	39 / 35 / 28 / 20	45 / 39 / 29 / 21	43 / 39 / 34 / 31	45 / 41 / 36 / 33	46 / 42 / 37 / 34
Sound Power (Cooling)		dBa	57	57	58	60	58	60	60
Outdoor Units			RXM20R9	RXM25R9	RXM35R9	RXM42R	RXM50R	RXM60R	RXM71R
Dimensions	Height x Width x Depth	mm	552 x 840 x 340	552 x 840 x 340	552 x 840 x 340	734 x 954 x 401	734 x 954 x 401	734 x 954 x 401	734 x 954 x 401
Weight		kg	32	32	32	49	49	49	55
Electrical Details	Power Supply		1ph	1ph	1ph	1ph	1ph	1ph	1ph
	Maximum Input Current (MCA)	A	8.93	9.71	9.76	10.36	14.54	15.09	19.78
	Max Fuse Size	A	10	16	16	16	16	16	20
Interconnection Wiring	Core / Cable size		3+E / 1.5	3+E / 1.5	3+E / 1.5	3+E / 1.5	3+E / 1.5	3+E / 1.5	3+E / 1.5
Piping Connections	Liquid / Gas	inches (mm)	1/4 (6.4) / 3/8 (9.5)	1/4 (6.4) / 3/8 (9.5)	1/4 (6.4) / 3/8 (9.5)	1/4 (6.4) / 3/8 (9.5)	1/4 (6.4) / 1/2 (12.7)	1/4 (6.4) / 1/2 (12.7)	1/4 (6.4) / 5/8 (15.9)
Pipework	Maximum Length	m	20	20	20	30	30	30	30
	Maximum Vertical Rise	m	15	15	15	20	20	20	20
	Precharged to	m	10	10	10	10	10	10	10
	Additional Charge	g/m	20	20	20	20	20	20	20
	Holding Charge	kg	0.76	0.76	0.76	1.10	1.15	1.15	1.15
Sound Pressure (Cooling)	Nominal	dBa	46	46	49	48	48	48	47
Sound Pressure (Heating)	Nominal	dBa	47	47	49	48	49	49	48
Sound Power (Cooling)		dBa	60	60	61	62	62	63	66
Operating Range (Cooling)	Min / Max	°CDB	-10 / 50	-10 / 50	-10 / 50	-10 / 50	-10 / 50	-10 / 50	-10 / 46
Operating Range (Heating)	Min / Max	°CWB	-21 / 18	-21 / 18	-21 / 18	-21 / 18	-21 / 18	-21 / 18	-15 / 18
Air Flow Rate (Cooling)	Nominal	m³/sec	0.600	0.472	0.600	0.777	0.777	0.777	0.817
Meets ETL criteria			•	•	•	•	•	•	•

Accessories

Accessory Ref	Description
EKRS21	Wire harness for S21 port for all marked (*) options
BRC073*	Wired remote control - connection cable required
BRCW901A03	3m extension cord required for wired remote controller BRC073
BRCW901A08	8m extension cord required for wired remote controller BRC073
K.CGM	Condensing unit guard (1150 x 1150 x 650)
K.CGS	Condensing unit guard (750 x 1050 x 460)
K.CWB90-2	Wall bracket (90kg, 500mm support arm)
K.DT1	Condensate drip tray for use with K.CWB90-2
KLIC-DDV3*	KNX interface for Split type systems
KRP413A15*	Adaptor PCB for remote on/off control - constant/pulse contact
KRP928A25*	Adaptor PCB for interface to Daikin centralised control systems
RTD-RA*	Adaptor PCB for Modbus connection and/or extended system functions

Notes & Features

- › All fan coils are supplied with infrared remote controller ARC466A67 (7-day schedule timer)
- › All fan coils have auto restart after power failure
- › Wired controller, KLIC-DDV3 and RTD-RA options cannot be combined
- › Night set mode
- › Air purification using Flash Streamer technology
- › Presence sensor and 2-area intelligent eye
- › Five fan speed can be selected; from high to super low
- › Heat boost function to reach set point quicker during start-up
- › Can be connected with R410A Mini VRV using BPMK boxes
- › RXM20-35R9 can reduce the sound power by a further 6 dB(A)

Multi split Less is more!

A Daikin multi split system offers you maximum flexibility and can reduce both environmental impact and cost. Create a practical and efficient home solution.

Less mounting space, less visibility, less sound

- › **Save space:** drastically reduce the space required for placing a number of units on your facade
- › **Less visibility:** enjoy your nice ambience. Finding just one hiding place is much easier
- › **Less noise:** only one unit in operation is much quieter than two or more units

Easier installation, wiring, piping and maintenance

- › **Save mounting equipment:** wherever you want to place an outdoor unit, for every unit you will need a mounting for a secure fixing and problem-free operation
- › **Save time:** installation, wiring, piping and initial setup is much easier and faster for just one system
- › Less problems: when using only one outdoor unit, the statistical probability of a **possible defect is reduced** with every unit that's not in use.

Lower power consumption, high efficiency

- › **Less power consumption:** our big compressors can work more efficiently than various smaller ones with the same capacity in sum. Also save a significant proportion of energy thanks to standby mode

More flexibility: connect up to five indoor units of any style

There are many configurations that will profit from a multi split solution:

- › **Up to five indoor units** connectable to only one outdoor unit
- › Every single indoor unit can be **regulated separately**
- › Choose from **a greater variety** of connectable indoor unit types from our split and Sky Air series
- › Use low capacity indoor units specially **designed for small rooms**, which can only be connected to a multi split system
- › Are you planning to add an **additional indoor unit later on?** Decide on an outdoor unit with higher capacity and simply connect it later

Pair split or multi split combination – the direct system comparison

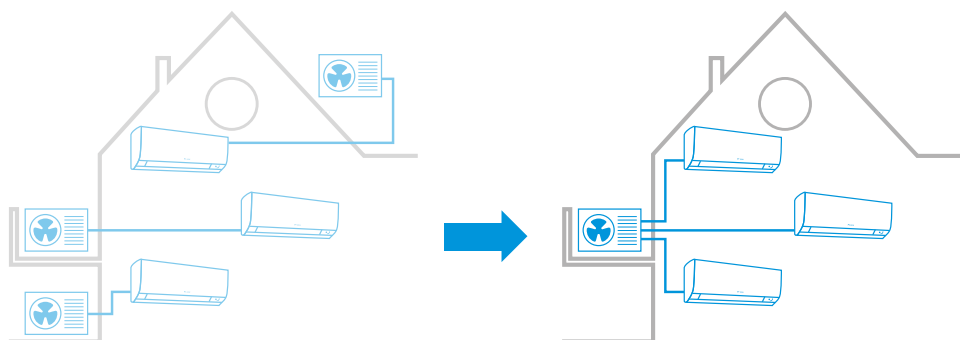

Conventional pair split installation for air-conditioning three rooms

Solution for the same situation with only one multi split outdoor unit



www.daikin.co.uk

Daikin Airconditioning UK Limited The Heights Brooklands Weybridge Surrey KT13 0NY Tel 01932 879000 daikin.co.uk

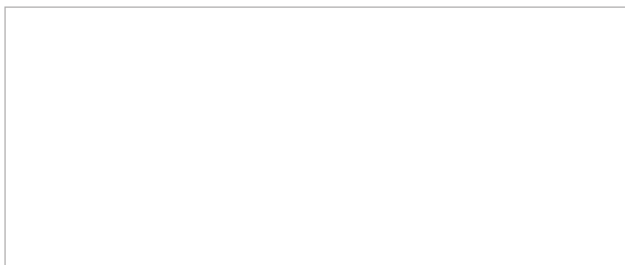

ECPEN23-008 08/2023



The present leaflet is drawn up by way of information only and does not constitute an offer binding upon Daikin UK. Daikin UK has compiled the content of this leaflet to the best of its knowledge. No express or implied warranty is given for the completeness, accuracy, reliability or fitness for particular purpose of its content and the products and services presented therein. Specifications are subject to change without prior notice. Daikin UK explicitly rejects any liability for any direct or indirect damage, in the broadest sense, arising from or related to the use and/or interpretation of this leaflet. All content is copyrighted by Daikin UK.

Printed on non-chlorinated paper.